

# **RE: REMOTE STORE MANAGEMENT**

REGISTER YOUR EMAIL TO USE THE NRS  
MERCHANT PORTAL TO ACCESS YOUR STORE  
VIA DESKTOP/LAPTOP PC AND TABLET

**-AND-**

**DOWNLOAD THE APP: "My NRS Store"**  
**ACCESS YOUR POS ONLINE @ [mystore.nrsplus.com](http://mystore.nrsplus.com)**

---

## **WE OFFER MULTIPLE ACCESS POINTS TO THE BACK OFFICE, VIA TWO OPTIONS:**

*Remote access to manage the store, from anywhere, anytime...!*

*View and organize the store remotely via phone, tablet and other devices.*

A) MERCHANT PORTAL ON DESKTOP/LAPTOP (ACTS AS A BACK OFFICE FOR THE POS) VIA  
MYSTORE.NRSPLUS.COM

-and-

B) "My NRS Store" APP

## **APP (SMARTPHONE AND TABLET):**

- Monitor sales by departments\*\*\*
- Add products to, or edit existing products in the pricebook (The phone's camera becomes a scanner)
- Track inventory levels
- Create in-store promotions
- Create one-click items
- Manage cashiers and their permissions

## **LAPTOP/DESKTOP:**

Visit [mystore.nrsplus.com](http://mystore.nrsplus.com) to log in with same credentials as the app

- Get all the same features as the App
- Coming soon! The ability to print customized reports off desktop/laptop

\*\*\*NOTE: Via app and laptop/desktop, merchant cannot view or access the POS register itself.

# **Read on for the 3 simple steps...**

- 1) **Your email address must be registered in the NRS Portal in your POS. IF YOU NEED ASSISTANCE, PLEASE CONTACT YOUR SALES AGENT OR NRS CUSTOMER SUPPORT (800) 215-0931.**

Go to the POS unit. Click on **TOOLS**.

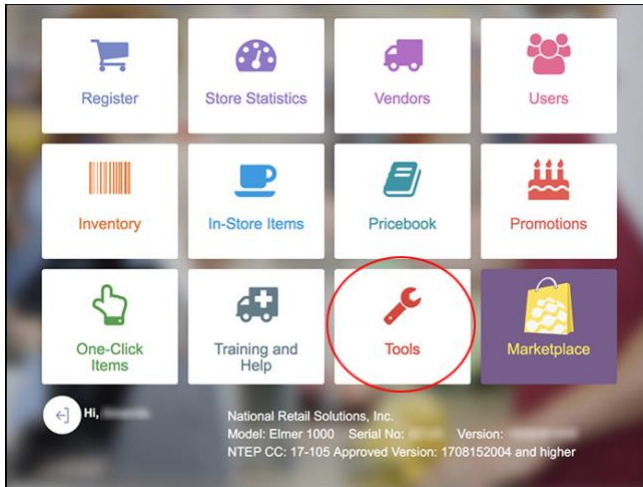

Click on blue button on bottom right, **STORE SETUP**.

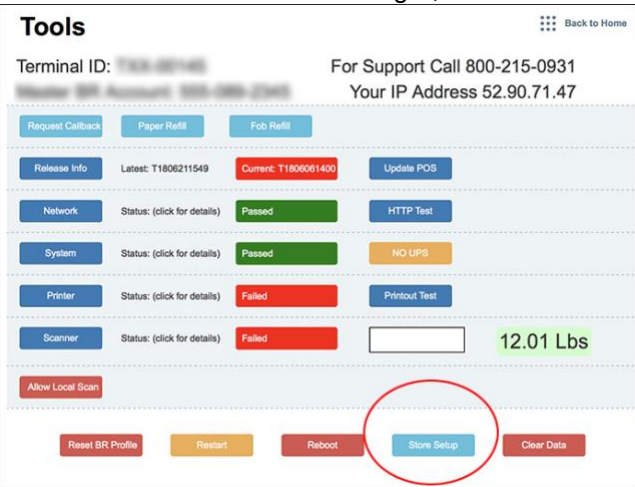

Now select top right tab, **PORTAL ACCOUNT**.

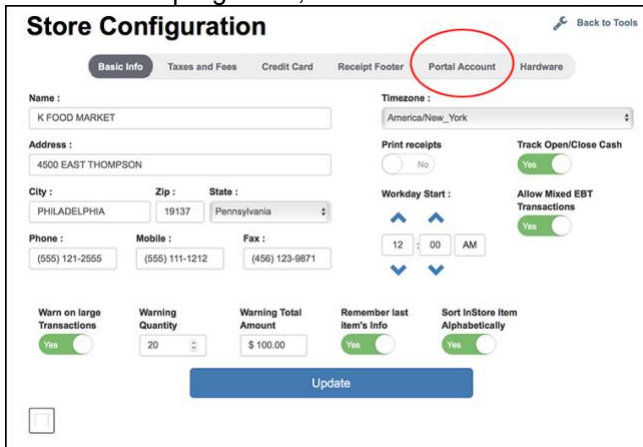

Enter your email address. After you enter your email, tap **REGISTER EMAIL**.

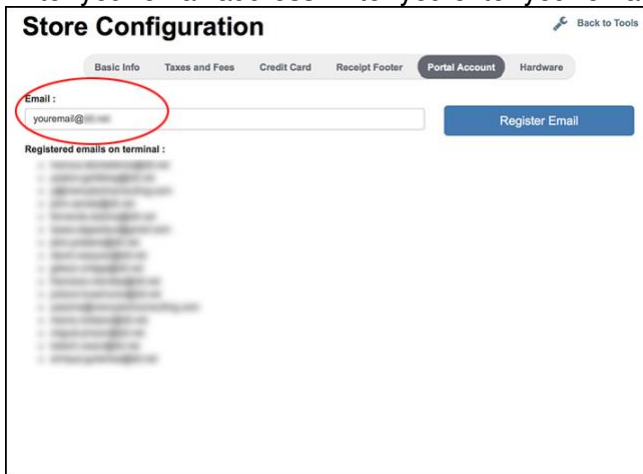

You will be sent an email from no-reply@NRS with a link, asking you to set up and verify your password. Follow those steps carefully to complete your password setup\*\*\*.

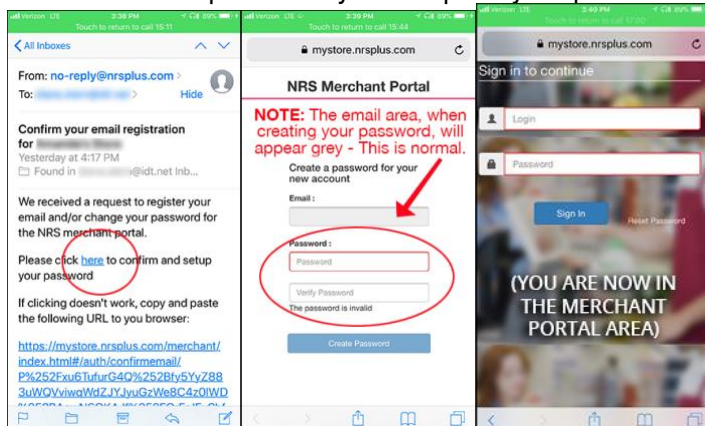

\*\*\*Please note that the password you set up for the portal (and app) should be a secure password. You should not use the simple 5 digit pin used to login to the POS. The reason is that with a weak password, others will be easily be able to break into the web portal for the store and be able to extract data and, even worse, change prices and remove items from the pricebook.

2) Next, on your smartphone, visit the App Store and search for My NRS Store. Download the app.

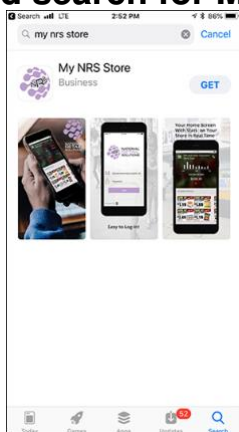

3) Open the app. If your email is not yet showing, enter it, and then enter your password\*.

You are now inside the NRS App - Congratulations!  
You're ready to use our app to remotely view your business.



\*The same credentials are used to log in to the back office online @ mystore.nrsplus.com