









## PORTABLE SHELF LABEL PRINTER

### Hardware Setup

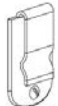
In the box, you will find the following contents-

- 1 printer
- 1 power cable
- 1 power box
- 1 belt clip
- 1 roll of shelf labels

Printer (1 set)	Battery (1 pcs)	USB cable (1 pcs)	Power adaptor (1 pcs)
			
Belt buckle	Label paper (1 roll)	Quick Installation Guide	Paper width adjusting unit
			

Turn the printer over exposing the battery compartment.



Click the button on the top left side of the printer to open up the top.

You will find a plastic roller inside.

Remove the protective film from the battery contacts.



Install the battery making sure that the latch is tight.

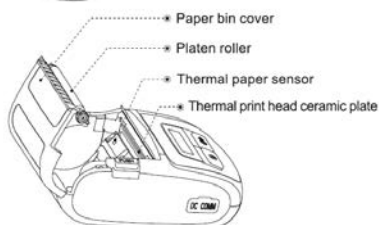

Take the plastic roller and pull off the loose side.

Slide the label roll onto the rod and fit the loose side back on.

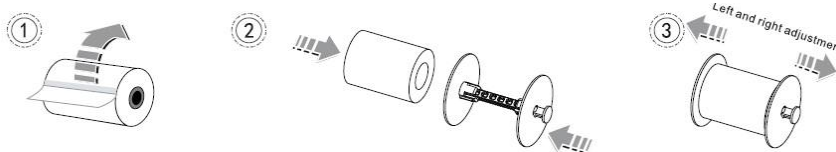

Now, put the labels into the printer compartment facing up and close the cover



Turn the printer on by holding down the front left button for about 5 seconds.

You will hear a long beep indicating that the Printer has been turned on.

The printer will auto calibrate and feed some paper through. Once it stops, you are ready to continue the pairing process.

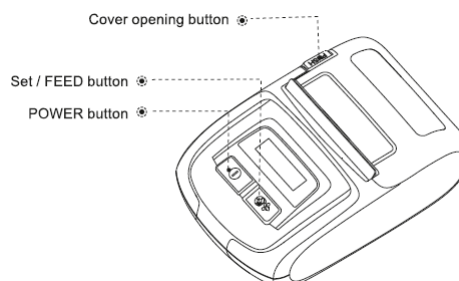

# Pairing Process for iOS

Make sure bluetooth is enabled on your device



Power on the printer by holding the left button on the top for about 5 seconds until you hear a long beep.



Next, on your phone, download and install the My NRS Store app. After it is installed, open the app.

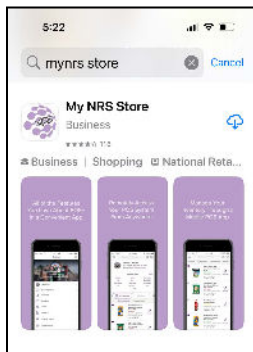

Login to the app using the same email and password that you used for the Merchant Portal.

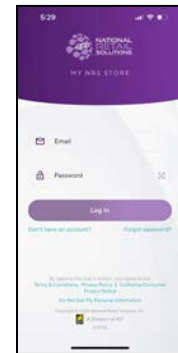

On IOS, when prompted, Tap Allow on the right hand side on the bottom for the MY NRS STORE APP to find bluetooth devices.

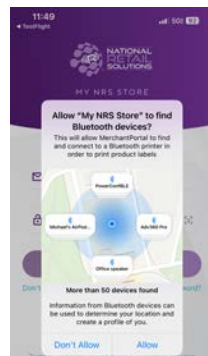

Next, Select the Search Products tile on the quick actions ribbon at the top of the app.

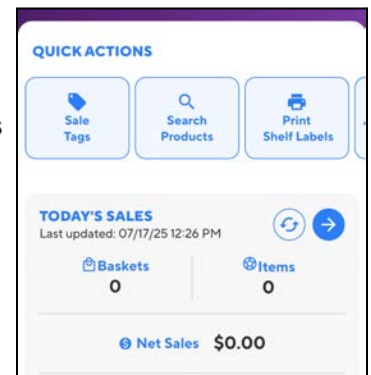

Find the item that you wish to print a shelf tag for.

You can type in the search bar at the top or scan the barcode with the camera.  
Tap the item description to open it up.

Click the blue print button on the bottom right corner.

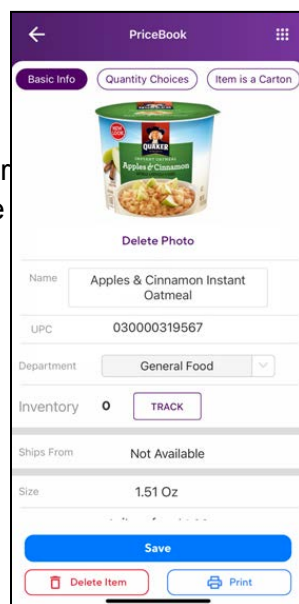

A pop up window will appear Asking you to select which printer you want to print to.

Select the **NRS Portable Shelf Label Printer** and then press the blue save button.

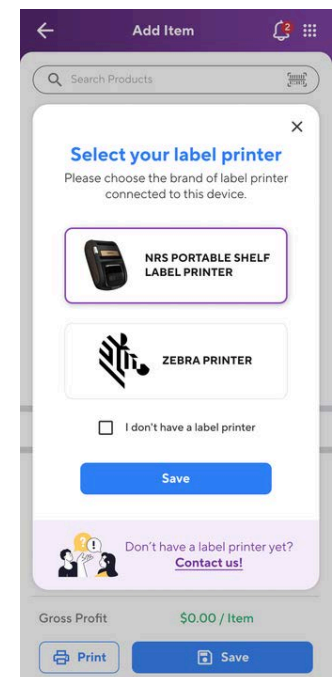



# Pairing Process for Android

Allow all permissions when asked

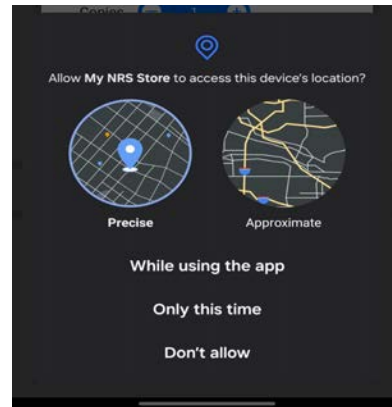
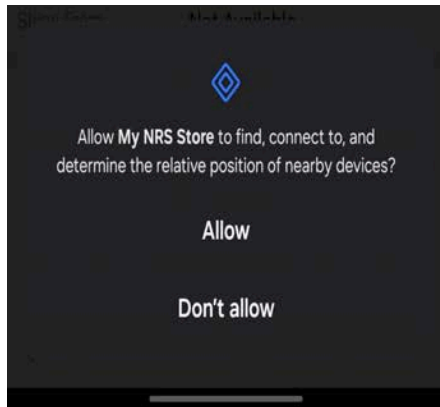

Tap the print button and select the printer from the bluetooth menu. You will see the name of the device on the printer's screen when tapping the left button on the top. In this case, the printer is called NRS-M1-XXXX-XXX. Once the printer is selected, tap SAVE.

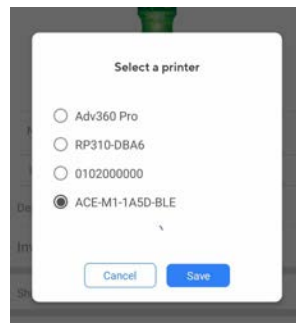
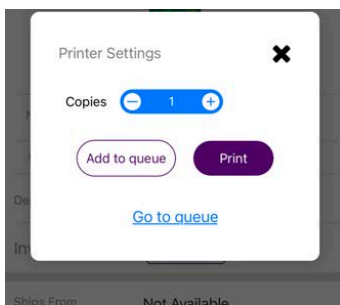

The printer will now print a label.

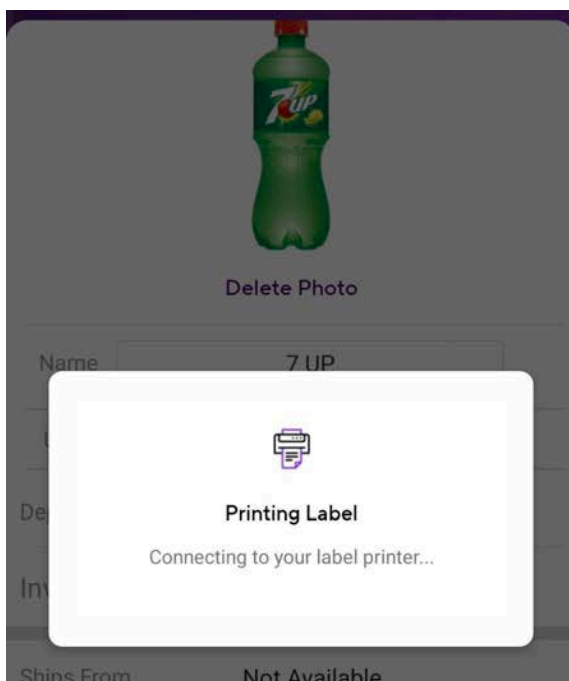

# Select Label Format

Go into the **PRINT SHELF LABELS** tile from the home screen



Select **STANDARD** or **CASH DISCOUNT** depending on which label type you want

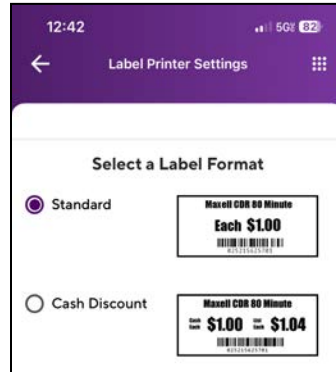
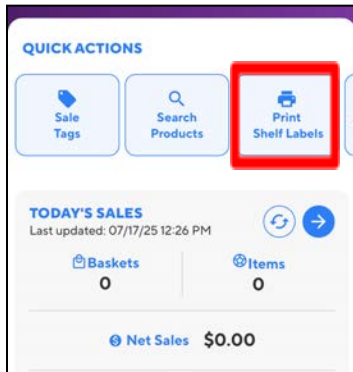

# Adding Items to Queue

This will allow you to add multiple products to your list and print all at once.

Go into the item page in your pricebook and select **Print**

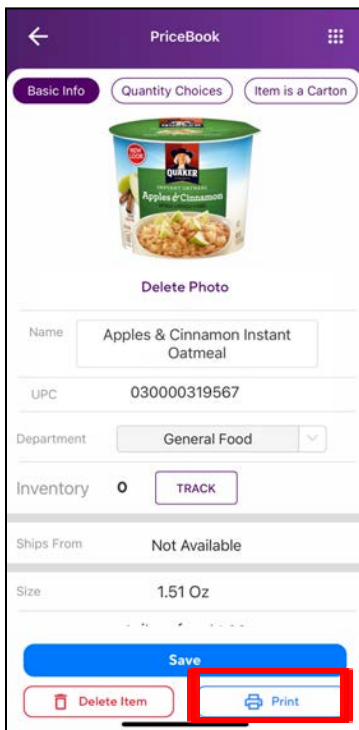

Click **Add to queue**

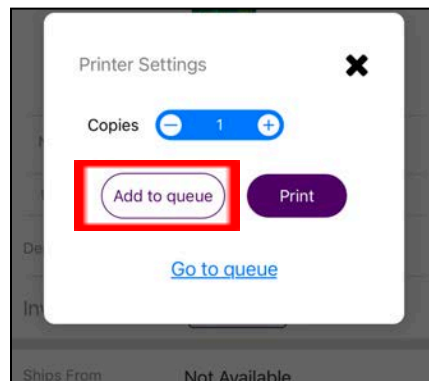

From the homescreen tap the **Print Shelf Labels** tile

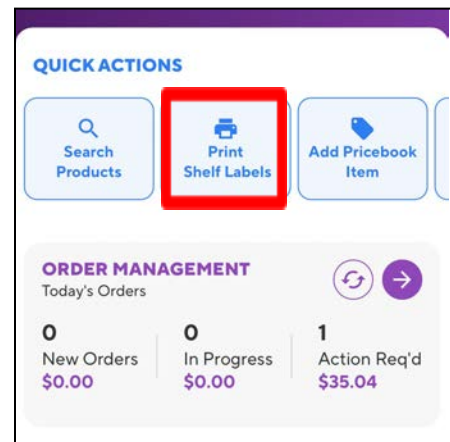

Select the items you'd like to print labels for or **Select All**. Make sure that you have chosen go to the quantity of each label that is required.

Then tap the **Print All Selected** button. Labels will now print.

